

SELF-GUIDED GRADUATE TOUR



Penn Law
UNIVERSITY of PENNSYLVANIA LAW SCHOOL

WELCOME TO PENN LAW!



This walking tour will guide you through the Law School's major architectural highlights and history and introduce you to Penn Law.

As you walk around the building complex, you will visit each of the Law School's four interconnected buildings that are set around a central courtyard. This architecture allows for easy and continuous interaction among faculty, students and staff – certainly contributing to the intellectual vitality of the Penn Law community – while simultaneously providing quiet spaces for study or reflection.

If you have any questions or need assistance while on this tour, please ask anyone whom you might meet as you explore Penn Law or return to the Office of Graduate and International Programs.



This Tour begins in the Office of Graduate and International Programs – Room 150 in Tanenbaum Hall. As you leave the that office, please GO STRAIGHT and walk into the Clock Lounge.



THE CLOCK LOUNGE

At Penn Law, we have two major student lounges: the “Clock Lounge” (where you are presently standing) and the “Goat Lounge,” located directly on the opposite side of the courtyard. These two Penn Law “landmarks” have become both gathering and meeting places ... with “meet me at the Goat” or “meet me at the Clock” frequently overheard. Several other smaller student lounges are located throughout the Law School complex.

The new plasma screen provides updated information about events, departmental news, and Law School news throughout the day. For a quick bite, students go to our vending area directly off the Clock Lounge, which also has a wide-screen television and comfortable seating, or to nearby eateries.

TURN RIGHT and WALK to the Journal Offices. CONTINUE along the hall, TURNING LEFT and then LEFT AGAIN until you return to The Clock Lounge.

PENN LAW JOURNAL OFFICES

Journal of Labor and Employment Law T-141-142

This Journal focuses on domestic and international labor and employment issues and seeks to provide an interdisciplinary analysis of those issues, drawing on fields such as law, economics, psychology, and sociology. This broad focus provides student editors with the opportunity to work with outstanding faculty in the fields of labor and employment.

The Journal of International Economic Law T-137-138

This Journal was started in 1978 by faculty, but became student run in 1983. Today, the Journal has subscribers from all over the world and is renowned as one of the top international and economic law journals in the world. The Journal covers transnational banking, trade regulation, antitrust and technology licensing.

The University of Pennsylvania Law Review T-123 & 134

The *University of Pennsylvania Law Review*, the nation's oldest Law Review, first appeared in 1852 as the *American Law Register* a publication of the Philadelphia Bar Association. Today the *Law Review* provides for the exchange of ideas from innovative proposals for change to scholarly commentaries on judicial, legislative, and administrative decisions. It is a reflection of the prevailing theories and perceptions of the legal community and thus serves as a forum for information and direction for both the practicing bar and the academic community.

Although the *Law Review* requires a significant amount of time and energy, its members make a valuable contribution to legal scholarship. Judges, scholars, students, and practitioners rely on the *University of Pennsylvania Law Review* articles and comments in writing opinions, briefs, and papers. Penn's *Law Review* is noted as fourth in the country for both the most frequently cited articles and the number of U.S. Supreme Court citations.

Journal of Constitutional Law

You will pass the Journal office later on your tour.

TURN RIGHT to leave The Clock Lounge. AHEAD to your RIGHT will be a staircase. GO UP the stairs to visit the Biddle Law Library. Feel free to explore the different floors of the Library. There is also an elevator down the final corridor of the Clock Lounge.



THE BIDDLE LAW LIBRARY

Biddle Law Library is one of the preeminent law libraries in the world. Today Biddle's collections house more than 825,000 volumes, including its foreign and international collections and rare book collections that are heavily used by the University of Pennsylvania community, other academic institutions, the Philadelphia Bar, and visiting scholars.

Biddle offers students small meeting and seminar rooms, quiet study spaces, and an inviting atmosphere for legal study. Through Biddle's on-line catalog, LOLA, students may search national bibliographic databases, the library catalogs of other major academic law libraries and periodical indexes. Several librarians teach formal and informal courses in legal research, and computer-assisted legal research training in Lexis and Westlaw is required of all students. Biddle Law Library is the research laboratory of the Law School. Its efficient operation and friendly, knowledgeable staff facilitate the intellectual agenda of the School.

EXIT the Library and RETURN back DOWN the stairs. WALK STRAIGHT AHEAD. On your RIGHT will be the Career Planning and Placement Office and the Public Service Suite.



CAREER PLANNING AND PLACEMENT

Room T113

CP&P coordinates and keeps on file a massive amount of information on law firms, government agencies, and public interest legal service, all cross-filed by region and type of practice. The dedicated staff serves all students, helping them identify their individual goals and dreams, teaching them the career planning skills necessary to reach those goals, and giving them access to as many employers as possible who meet those goals. One CP&P counselor is specifically dedicated to advising graduate students on how best to use the resources available through CP&P.

[Each year, some LL.M. students attempt to find employment in the United States, either permanently or on a temporary basis (e.g., several months to a year or two to before returning to their home countries). It is important to note that the U.S. legal market is overwhelmingly oriented towards J.D. graduates. Only a very small percentage of LL.M. graduates, regardless of their U.S. law school, are able to find law-related jobs in the United States today. We urge prospective LL.M. students to research this fact, and other employment options, before enrolling at Penn Law.]

SECURITY DESK

Penn Law has two entrances. You are standing at our main entrance on Sansom Street where Cormel is likely to be there to greet you as you come in. Theresa would undoubtedly be there to welcome you at our other entrance on 34th Street.

PUBLIC SERVICE PROGRAM

Room T 110

To do justice . . . it is one of the strongest callings of the law and legal profession. At Penn Law, all law students have an opportunity to learn more about representing the interests of the disenfranchised, the underrepresented, work with the non-profit and government sector or a non-profit advocacy group. JD students have a mandatory 70 hours of law-related public service. Penn Law is the only law school to have won the ABA's Pro Bono Publico award for a public service program.

Created in 1990, the Public Service Program matches students with pro bono placements in the Philadelphia region or nationally from a selection of several hundred public interest organizations, governmental agencies and non-profit organizations. Students can also initiate new projects that reflect their own interests.

ADMINISTRATIVE OFFICES

CONTINUE STRAIGHT down the Hallway to the Administrative Section of the Law School. On your RIGHT you will pass the Deans' Suite, the Registrar's Office and Administrative Services.

Notice Boards

In addition to a very active email notice system, these boards serve as another means of communication for both departmental and student activities as well as Law School news. The "Students and Faculty in the News" board gives highlights of recent print media in which faculty or students were cited.

Display Cases

The three display cases office the Deans' Suite exhibit faculty scholarship, introduce new faculty to the Penn Law community, and provide program information.





Deans' Suite -- Room P 101

The Deans' Suite is the center of many of the executive operations of the Law School.

Michael A. Fitts, Dean

Michael Fitts' vision for creating a cross-disciplinary legal education continues to place Penn Law at the forefront. Our program is multifaceted, starting at the Law School and maximizing the advantages of the University's superb graduate and professional schools. More about the program is available below in the Registrar's section.

Student Affairs

This office is responsible for academic and non academic student affairs, among other things. When students ask themselves the inevitable question, "Why am I in law school?" Gary Clinton, the Associate Dean for Student Affairs, is more than willing to lend a helpful and understanding ear. He also counsels students with academic concerns, and helps students make arrangements in case of emergencies. His office is also the liaison to student organizations at the Law School.

Communications Office

Aside from handling all of the print and web communications, the Communications Office provides graphic and design support for publicity materials for student organizations presenting symposia or lectures.

Office of the Registrar

Room P 103

This office is the nerve center of the Law School's daily operations. The Registrar and her staff run one of the most helpful offices on campus. Chances are if they can't answer your questions, they will tell you who can – with a smile!

The Registrar's Office offers assistance with the following:

- Course scheduling and registration (assigns students to most first year courses)
- Exam scheduling
- Exam distribution
- Grades
- Transcripts
- Accessing individual admissions files
- Reserving rooms for study groups
- Forms verifying enrollment status

General Academic Information

Graduate students start their Penn Law year during the summer, taking two mandatory courses introducing them to U.S. law and research methods. The course, English as a Second Language, is also available. This summer program allows the LL.M. class to create bonds before the J.D. students return to school in the fall.

Graduate students take classes with the upper level J.D. students and are graded by the same standards. They can, however, request permission to have additional time for exams if their proficiency in English warrants.

Vice Dean for Administrative Services -- Room P 103

The Vice Dean focuses her efforts on implementing the Law School's strategic plan and on ensuring that students are well served by the various administrative groups at Penn Law. She also works with the Associate Dean for Student Affairs on streamlining administrative processes with the Law School's joint degree programs.

THE GOAT LOUNGE

Sculpture by Henry Mitchell (1962)



As we mentioned when you were in the Clock Lounge, the Goat Lounge is our other main student gathering spot. The "Goat" is also the name of our Intranet site.

Named after the statue that stands in the center of the student lounge, "The Goat" is actually a Hsieh-Chai, an animal from Chinese lore dating back to the days of Shun (circa 2200 B.C.). Hsieh-Chai was goat-like, but bore only one horn, and was endowed with the faculty of detecting the guilty. According to legend, when the famous minister Kao Yao tried cases in which guilt was uncertain, he would use Hsieh-Chai to distinguish between the crooked and the upright. Donated by a Faculty member, the sculpture adorns the Law School as a reminder of how far the judicial process has developed.

As the quote on the dedication plaque reads:

"SLOW AND PAINFUL HAS BEEN MAN'S PROGRESS FROM MAGIC TO LAW"

PENN LAW'S DISTINGUISHED HISTORY

The Law School's historical highlights are displayed on a timeline, located on the outer walls of the Goat Lounge. This timeline starts in 1790 with James Wilson's first law lecture to President George Washington and Vice President John Adams, to the official founding of the Law School by George Sharswood in 1850 when he became Dean, and concludes with more recent Penn Law milestones.

A more complete history of Penn Law can be found on our website at <http://www.law.upenn.edu/about/history/index.html>.

With your back towards the courtyard, please PROCEED straight through the doorway to your RIGHT and ENTER The Great Hall.

GREAT HALL

In its early years, the Law School was located near the downtown courts and law offices in order to maintain the necessary balance between classroom instruction and clinical training. In 1900, the Law School made the bold move to relocate, joining the rest of the University at the new West Philadelphia campus. The University community and distinguished jurists from across the country gathered to dedicate a new Law School building celebrated as, "the most completely beautiful and most beautifully complete building ever designed for the sole purpose of housing a law school." The exterior of the building, designed in the English classic style of the time by the famous Philadelphia firm of Cope and Stewardson, incorporates shields and medallions bearing the names of great figures in the history of Anglo-American common law.





The building once was named Lewis Hall in honor of William Draper Lewis, the Law School's Dean from 1896 to 1914. Restored and revitalized in conjunction with the Law School's sesquicentennial, the building is now named for honored Penn Law alumnus, Henry R. Silverman.

The Great Hall serves as an elegant location for numerous Penn Law receptions that follow symposia and major lectures that are held upstairs in the Levy Conference Center or elsewhere at the Law School.

Faculty Lounge S-144

Just off the Great Hall you will find the Faculty Lounge where faculty gather and hold faculty ad hoc lectures.

Sadie T.M. Alexander Portrait (next to the security guard's desk)

Sadie T.M. Alexander, 1927, the first African American woman graduate of the Law School, lived a life of service and accomplishment. Her father, Aaron A. Mossel, was the School's first African American graduate, receiving his degree with the class of 1888.

At Penn Law, we continue our tradition of fostering a community committed to diversity: diversity of students, faculty and staff, and diversity in intellectual perspective, in philosophy, in politics, in background, in experience, and in viewpoint. Diversity enhances the process of legal education and contributes greatly to the excellence of the Penn Law experience. Penn Law successfully matriculates a diverse student body, with students of color representing over 35% of each J.D. class. We also have approximately 85 graduate students enrolled from all over the world.

Faculty Offices

Rooms S 125 – 143 & S 148-162

Faculty offices extend off both sides of the Great Hall and are also located in the newly renovated Gittis Hall. This close proximity of faculty to each other and to students enhances the intellectual vigor of the Law School.

Most professors are easily accessible after class, by email, or in their offices. There are official office hours or you can just stop by. Students often meet with faculty members to discuss class material, job searches, clerkships, or to meet a professor before going to lunch.

A longstanding Penn Law tradition is that first-year students have lunch with each of their professors in small groups throughout the academic year.

Awards Display Case

The glass case at the east-end of the Great Hall displays some of the many awards received by Penn Law students

GRAND STAIRCASE

Please PROCEED UP the Stairs and STOP at the first Landing.

Lincoln's Bust

This unusual sculpture is of a young shorn "Honest Abe," representing Lincoln as a successful Springfield lawyer. As one of the leading lawyers in the 1850s in Illinois, Lincoln did not specialize as was the custom of the day. He practiced in the federal courts, tried cases before the Illinois State Supreme Court and handled cases before justices of the peace.

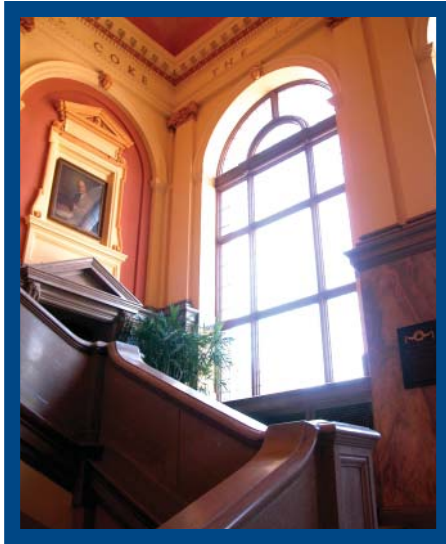

Quotation:

"TRUTH, SIMPLICITY, AND CANDOR: THESE ARE THE CARDINAL VIRTUES OF A LAWYER."

~ SHARSWOOD ~

In 1850, George Sharswood, President Judge of the District Court of Philadelphia, was appointed Professor of Law, marking the University's commitment to the establishment of a school of law. Sharswood served as the School's first dean and implemented a rigorous, practically-based academic program – consisting of law lectures, recitations, essays, and forensic discussions – to complement the requisite clerkship under the direction of a practicing Attorney. Through Sharswood's leadership of addressing legal ethics, government service, and general issues in public morality, the Philadelphia Bar came to view the Law School as a place where the profession could transcend "mere money-making business" and offer guidance on the political and economic conflicts in society.

With your back to the Bust of Lincoln, CONTINUE up the LEFT branch of the stairwell and stop at the top landing. You should be facing a portrait of Judge A. Leon Higginbotham Jr.

Portrait: Judge A. Leon Higginbotham Jr.

A. Leon Higginbotham Jr. was appointed a judge of the U.S. District Court for the Eastern District of Pennsylvania in 1964, and a judge of the U.S. Third Circuit Court of Appeals in 1977.

His association with the University of Pennsylvania was a long and distinguished one: Adjunct Professor of Law from 1971 to 1992, Trustee of the University from 1968 to 1994, and member of the Law School's Board of Overseers from 1978 to 1990, serving as its chair from 1979 to 1992.

Other Portraits

The other portraits that grace the stairwell are (clockwise from Judge A. Leon Higginbotham Jr.):

- **George Wharton Pepper** – Graduated first in his class from Penn Law in 1889 and taught at Penn Law from 1892 to 1910. He served as a U.S. Senator from 1922 to 1927.
- **Edward Coppee Mitchell** – Professor and Dean of the Law School from 1873-1886. Mitchell taught real estate, conveyancing, and equity jurisprudence. During his tenure, Roman Catholics and Jews were admitted without quotas, and the first woman, Carrie Burnham Kilgore, was admitted in 1881.
- **Francis H. Bohlen** – Graduated from Penn Law in 1892. Professor from 1898 to 1938. Bohlen was an expert on Torts. He was the reporter for the American Law Institute's first Restatement of Torts.
- **John Marshall** – the "Great Chief Justice" molded the Constitution through his interpretations.
- **James Wilson** – First Professor of Law at Penn (please see description of Wilson's bust on page 10)

Quotation:

"THE LAW IS UNKNOWN TO HIM THAT KNOWETH NOT THE REASON THEREOF AND THE KNOWNE CERTAINTIE OF THE LAW IS THE SAFTIE OF ALL" - COKE

This quotation by Sir Edward Coke, one of the most eminent jurists in the history of English law, is drawn from his famous treatise, *The First Part of the Institutes of the Laws of England* (1628). Coke entered Parliament in 1589 and rose rapidly, becoming Solicitor General and Speaker of the House of Commons. In 1593 he was made Attorney General. In 1606, he became chief justice of the common pleas. In this position, and (after 1613) as Chief Justice of the King's Bench, Coke became the champion of common law against the encroachments of the royal prerogative and declared null and void royal proclamations that were contrary to law.

Journal of Constitutional Law (top of the landing)

One of several prestigious, student-edited journals at Penn Law, the *Journal of Constitutional Law* provides a forum for the interdisciplinary study of and rigorous analysis of constitutional law. The Journal cultivates innovative scholarship, promotes critical perspectives, and reinvents the traditional study of constitutional law. To encourage dialogue about the Constitution within and between diverse communities, The Journal hosts an annual symposium and publishes in both print and electronic media. The Journal has a relationship with the National Constitution Center, located in Philadelphia, and has a cross-disciplinary relationship with Penn's Political Science Department, School of Social Policy & Practice, the Medical School, and Wharton.

Institute of Law & Economics (directly opposite the Journal of Constitutional Law)

Founded in 1980, the Institute for Law and Economics has an ambitious agenda. Under the sponsorship of Penn Law, Wharton and the Department of Economics, the Institute has played a leading role in this field, one of the fastest growing areas in legal scholarship. Cross-disciplinary research, the cornerstone of ILE, seeks to influence the national policy debate by analyzing the impact of law on the global economy, spotlighting the significant role that economics plays in fashioning legal policy. The innovative roundtables and conferences complement these goals by provoking in-depth and, frequently, ground-breaking examinations of critical issues.

Facing the portrait of Judge Leon A. Higginbotham Jr., WALK to your RIGHT and enter the doorway on your LEFT.

Keedy Cup

On the right side of the entrance sits the Keedy Cup and a listing of previous winners of this prestigious Moot Court competition. Named for former Law School Dean Edwin R. Keedy, the Keedy Cup is awarded to the winning team in the Law School's intramural appellate advocacy competition. The Keedy Cup argument is held every January before a panel of eminent judges.

Walk through the doorway and STOP in the hallway of the Levy Conference Center.



2ND FLOOR CORRIDOR



Bust of James Wilson

James Wilson – signer of the Declaration of Independence, framer of the U.S. Constitution and, later, Associate Justice of the U.S. Supreme Court – became Penn’s first professor of law in 1790. In December of that year he initiated his law lectures with an introductory address before President George Washington, Vice President John Adams, members of both houses of Congress, and other luminaries.

Facing the Bust of Wilson, TURN LEFT and WALK down to the end of the Hallway.

Kabacoff Reading Room and Classrooms S 240 A & B

These classrooms occupy the space that once housed Penn’s famous Biddle Law Library. These rooms blend historical architecture with modern technology. Each desk is wired for laptop use or students can use wireless. Professors have the latest audio/visual equipment available for use during their lectures.

As you return to the Hallway, WALK all the way to the opposite end, PASSING Alumni and Development Offices on your LEFT, and STOP at the main hall of the Levy Conference Center (Room S 245)

Levy Conference Center

The Levy Conference Center is the site of numerous events, symposia, and lectures – essentially serving as the Law School’s hub for larger assemblies of students, faculty, and practitioners on everything from Delaware corporate law, the nature of human rights in China, to the future of the Internet to the Equal Justice Foundation’s Annual Auction. It is also where you might hear a Supreme Court Justice, a leading economist, or an expert panel.

Please turn RIGHT from the entrance to Levy Conference Center and PROCEED into the Bernard Segal Moot Court Room

Bernard Segal Moot Court Room - Room S 245 A

The Segal Moot Court Room is a first-rate facility which can be set up to simulate a small appellate courtroom, giving future litigators a place to refine their oral advocacy skills.



Appellate Advocacy II is the Law School's second-year intramural Moot Court competition. The students research and write a brief and then present their case in one or perhaps two rounds of oral argument before a panel of students, faculty and practitioner judges.

The competition results are ranked: the top four students become the third year Keedy Cup Teams (working on a new brief in the fall semester of their third year, and arguing before a panel of distinguished jurists); the next three students represent Penn at the National Moot Court Competition in their third year; and the next seven students become members of The Moot Court Board in the next academic year. Board members prepare problems and review the work of contestants.

In recent years, Penn students also have participated in the National Moot Court Competition (Bar Association, City of New York), the Merna B. Marshall Moot Court Competition (Federal Bar Association, Philadelphia Chapter), The Frederick Douglass Moot Court Competition (National Black Law Student Association), and the Jessup Cup Competition (Columbia Law School).

As you LEAVE the Levy Conference Center, follow the hallway back to the stairwell. GO DOWN stairs back into The Great Hall. At the bottom of the stairs, turn to your LEFT and walk behind the main staircase and take another set of stairs leading to the lowest level of Silverman Hall. At the bottom of the stairs, TURN RIGHT, WALK straight, and go through the door leading to the hallway and reception area of the Gittis Center for Clinical Legal Studies.

DOWNSTAIRS SILVERMAN

Gittis Center for Clinical Legal Studies



The Gittis Center for Clinical Legal Studies is a multi-faceted clinical law practice and state-of-the-art teaching law office located in the heart of the law school complex. Opened in 1996, the Center contains faculty offices, a student lawyering center and video-equipped conference rooms and a separate client entrance directly to the street. Most of Penn's renowned clinics are here, including the Civil Practice Clinic, Entrepreneurship Legal Clinic, Mediation Clinic, Legislative Clinical, Interdisciplinary Child Advocacy Clinic, Lawyering in the Public Interest, and the new Transnational Clinic. The Criminal Defense Clinic is located downtown, and Externships are off-site.

The Center's mission is the development of student competency in lawyering skills, appreciation of role and sensitivity to ethical issues while delivering the highest quality service to clients in the Philadelphia area. Over the past two decades, Penn's history of anticipating professional changes and tailoring its clinical training to major roles lawyers play has earned it a reputation for educational innovation, outstanding program design and rigorous preparation of its graduates for entry into law practice. Limited places are available to LL.M. Students

Returning to the hallway, GO STRAIGHT, past the staircase, and farther down the hall where several student group offices are located in this area of the Law School.

Student Lockers

This is one area in which students have lockers. Students select their lockers from several of the convenient locker areas throughout Penn Law.

TURN AROUND AND TAKE the stairs back up to The Great Hall. WALK STRAIGHT towards the Security Desk. At the Security Desk, TURN LEFT and PROCEED down the hallway marked Rooms S 148-162.

Shuster Room for Teaching of Dispute Resolution - Room S 147A

This trial courtroom gives students a “real world” setting in which to practice their trial skills as they would in a real courtroom. Presentations can be video taped and monitored from an adjacent classroom and from faculty offices.

Continue walking past Silverman Hall faculty offices, FOLLOWING the Hallway around to the LEFT. At the end of the Hallway, PASS STRAIGHT THROUGH the vestibule and enter the bottom of a stairwell. TURN LEFT, then a quick RIGHT, exiting the stairwell into Gittis Hall.

GITTIS HALL

Gittis Hall has 21 modern faculty offices, classrooms, and a small student lounge upstairs. As you continue down the hall, you will see a display case that honors some of our earlier Honorary Fellows award winners. Each year one of the graduation speakers is a person who has made a significant contribution to Public Interest.

GO STRAIGHT UP THE STAIRS and you will come to two new classrooms and another student lounge.

Gittis Hall Lecture Rooms

Four state-of-the-art classrooms were opened in January 2006 in Gittis Hall. Each classroom is sound-proof to the street, has two projector screens, and all of the latest technology to facilitate teaching. These rooms also serve as the site for numerous lectures and symposia.

RETURN DOWN the stairs, GO STRAIGHT to the glass doors leading outside. EXIT Gittis Hall through the glass doors. TURN LEFT and GO DOWN the steps into the Courtyard.



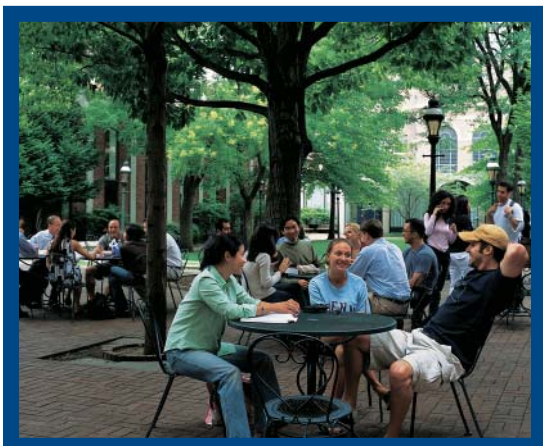

The Courtyard

The Courtyard is a wonderful oasis where students can gather or have a bite to eat with friends or a faculty member. You will see throngs of students socializing, enjoying the sunshine and fresh air, and even finding a quiet spot to study. Penn Law is wireless, so students can have easy access to their laptops even in the Courtyard.

Facing out into The Courtyard from the bottom of the steps, please TURN to your RIGHT and enter the first set of glass doors on your RIGHT. This will bring you back into Tanenbaum Hall. WALK STRAIGHT AHEAD past Ball Seminar Room back towards the Admissions and Financial Aid area where you started.

SOME HELPFUL INFORMATION

Office of Graduate and International Programs -- Room T 150

The Office of Graduate and International Programs coordinates the entire LL.M. year at Penn Law. From arranging trips to Washington D.C. to counseling students seeking employment in the U.S. or dealing with family emergencies, they are there for students.

CONTACT INFORMATION

Phone: 215.898.0407
Fax: 215.898.6979
Admissions Email: gradadmissions@law.upenn.edu

WE WOULD LIKE TO THANK YOU FOR YOUR VISIT AND FOR TAKING
THE SELF-GUIDED TOUR OF PENN LAW.

IF YOU HAVE ANY QUESTIONS, PLEASE CONTACT US:

GRADUATE AND INTERNATIONAL PROGRAMS

TEL: +1 215-898-0407
GradAdmissions@law.upenn.edu
www.law.upenn.edu



CHESTNUT STREET

GITTIS HALL

TANENBAUM HALL

Gate

SILVERMAN HALL

COURTYARD

34TH STREET

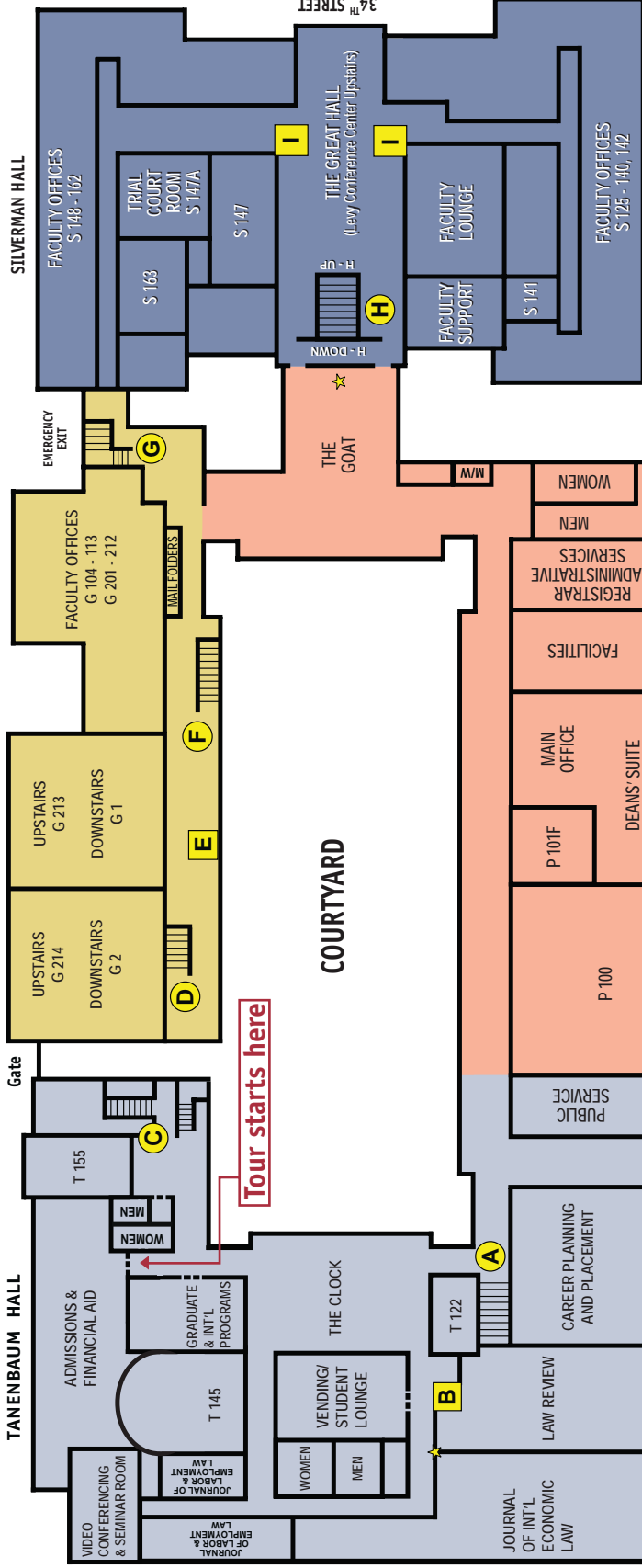

Tour starts here

- P – Pepper Hall
- G – Gittis Hall
- S – Silverman Hall
- T – Tanenbaum Hall
- – Stairs
- – Elevator
- ★ – Public Phones

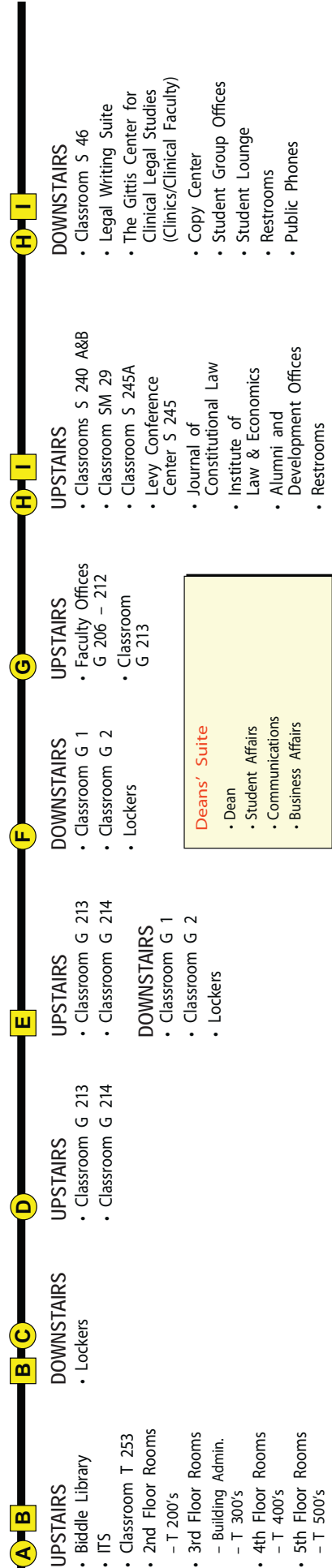

- A B** UPSTAIRS
 - Biddle Library
 - ITS
 - Classroom T 253
 - 2nd Floor Rooms
 - T 200's
 - 3rd Floor Rooms
 - Building Admin.
 - T 300's
 - 4th Floor Rooms
 - T 400's
 - 5th Floor Rooms
 - T 500's
- B C** DOWNSTAIRS
 - Lockers
- D** UPSTAIRS
 - Classroom G 213
 - Classroom G 214
- E** UPSTAIRS
 - Classroom G 213
 - Classroom G 214
- F** DOWNSTAIRS
 - Classroom G 1
 - Classroom G 2
 - Lockers
- G** UPSTAIRS
 - Faculty Offices G 206 – 212
 - Classroom G 213
- H I** UPSTAIRS
 - Classrooms S 240 A&B
 - Classroom SM 29
 - Classroom S 245A
 - Levy Conference Center S 245
 - Journal of Constitutional Law
 - Institute of Law & Economics
 - Alumni and Development Offices
 - Restrooms
- H I** DOWNSTAIRS
 - Classroom S 46
 - Legal Writing Suite
 - The Gittis Center for Clinical Legal Studies (Clinics/Clinical Faculty)
 - Copy Center
 - Student Group Offices
 - Student Lounge
 - Restrooms
 - Public Phones

Deans' Suite

- Dean
- Student Affairs
- Communications
- Business Affairs